



The State Board of Workers' Compensation
**2006 ANNUAL
EDUCATIONAL CONFERENCE**

It's a **JUNGLE** out there...



Learn The Right Path!

August 27 - 30, 2006  Renaissance Waverly Hotel

INSIDE FRONT COVER
(BLANK)

Welcome To Our Conference



On behalf of Directors Viola Drew, Warren Massey, Executive Director, Stan Carter, and the entire staff of the State Board, I want to welcome each of you to our 2006 Annual Educational Seminar. As the agenda reflects, an outstanding faculty will be sharing their expertise on a broad spectrum of pertinent workers' compensation issues. We are very pleased to have noted speaker, Richard Pimentel, join us to present the keynote address on Wednesday morning. On Tuesday evening the dinner and dance will provide great entertainment and an opportunity to relax and enjoy each other's company.

As always, this past year has been one of opportunity and challenge. In 2004, we began work on our technology initiative, the Integrated Claims Management System, to move from a paper-based to an electronic, web-based claims management system to be rolled out in four phases. Phase 1 was rolled out in October of 2005, covering document reception and claims processing, and Phase 2 was implemented in July of 2006. We expect the following two phases to be implemented and in place sometime this winter. As with any initiative of this scope we have encountered some challenges and are working hard to resolve problems that arise. We are already experiencing some of the benefits the system will bring. ICMS will enhance our ability to serve all of the constituents of the workers' compensation system and to administer the law more effectively. Service is, and will remain, our top priority, and we at the Board greatly appreciate the patience and assistance of everyone involved.

The Board continues our strong commitment to educational programs, through Regional Seminars and this annual conference. The knowledge shared through the presentations of the faculty and the networking opportunities among our attendees ensure the effectiveness of our workers' compensation system here in Georgia. Thank you for your attendance, your support, and all your efforts throughout the year.

Sincerely,

A handwritten signature in black ink that reads "Carolyn C. Hall". The signature is written in a cursive, flowing style.

Carolyn C. Hall
Chairman

General Information

REGISTRATION

The registration and information desk is located in the Garden Court area.

NAME TAGS

All participants will need to wear name tags for admission to the seminar meetings.

SEMINAR STAFF

The seminar staff may be recognized by name tags with staff ribbons and yellow shirts. Please let any member of the staff know if you need information or assistance.

EXHIBITS

Exhibits are displayed in the Garden Court area and Ballrooms III & IV and will be open during the following hours:

Sunday, August 27, 2006	6:00 – 7:00 p.m.
Monday, August 28, 2006	8:30 – 3:30 p.m.
Tuesday, August 29, 2006	8:30 – 3:30 p.m.
Wednesday, August 30, 2006	8:30 – 12:30 noon

Please refer to the Exhibitor Profile section in this program.

EXTRA BANQUET/DANCE TICKETS

Extra party tickets for Tuesday evening may be purchased in the registration area for \$50.00 each. **YOU MUST HAVE A TICKET FOR ADMISSION.**

DOOR PRIZES

General Attendance Door Prize: To be eligible, visit the exhibit space located in the Garden Court area of the hotel and have at least 50 of the exhibitors initial the card on the exhibitor card that is located inside your attendee packet. Drop the card in the box at the registration desk. The name will be drawn and posted during the 10:45 a.m. Coffee Break on Wednesday. **YOU DO NOT HAVE TO BE PRESENT TO WIN.**

Wednesday Attendees Only Door Prize: A ticket will be given to you as you enter the Wednesday morning session. A staff member from the Board will take the other portion of the ticket. The ticket number will be drawn at the end of the session on Wednesday. **YOU DO HAVE TO BE PRESENT TO WIN.**

Exhibitor Door Prizes: To be eligible for the door prize donated by exhibitors, you must drop your business card in the container provided at each booth. A separate drawing will be held for each door prize, and the winners will be posted during the coffee break on Wednesday, August 30, 2006 at the exhibitor registration and information table in the Garden Court area.

RESTAURANTS

Renaissance Waverly Hotel: The Waverly Grill, The Atrium Cafe', Saddles Sports Bar and The Waverly Coffee Bar.

Galleria Mall: China Sun Express, Subway, Jocks & Jills

Special Thanks to the 2006 Steering Committee

- **Donna Anderson**
Integrated Care Management
- **James P. Anderson, Esq.**
Drew Eckl & Farnham, LLP
- **Jeanette Bass**
Mohawk Industries, Inc.
- **Joan P. Bauch**
Ability Services Network, Inc.
- **N. Staten Bitting, Jr., Esq.**
Fulcher Hagler, LLP
- **Peter K. Braul**
HomeNurse, Inc.
- **Manuel S. Campano, Esq.**
Campano & Sperling, LLC
- **Judith Carr**
MedSynergy
- **Robyn Carter**
The Center for Orthopaedics & Sports Medicine
- **Connie Chandler**
United Parcel Service
- **Jennifer Chapin, Esq.**
Savell & Williams
- **Sharif R. Cheatham, Esq.**
Goodman, McGuffey, Lindsey & Johnson, LLP
- **Carrie Christie, Esq.**
Rutherford & Christie, LLP
- **Melissa Clyatt, Esq.**
Melissa M. Clyatt & Assoc., P.C.
- **Gloria Cook**
Medical Services Company
- **Stephen Dawkins, M.D.**
Caduceus Occupational Medicine
- **Gail Duke**
Medical Services Company
- **Sandra Elliott**
Cobb County School District
- **Dr. Richard Gadd**
Chiropractor
- **Marcia Hauler**
Concentra Medical Centers
- **John Heller, M.D.**
The Emory Spine Center
- **Tom Herman, Esq.**
Westmoreland, Patterson & Moseley
- **Tom Holder, Esq.**
Long & Holder
- **Foy S. Horne, Esq.**
Attorney at Law
- **Robert Howell, M.D.**
Georgia Hand & Microsurgery
- **Matthew Javersak**
Beverly Enterprises
- **Bill Johnson, Esq.**
Moore, Ingram, Johnson & Steele (CHAIRMAN)
- **Linda Judge**
Builders Insurance Group
- **Ainslie Kriston**
Northeast Georgia Medical Center
- **Lynn Long, R.N.**
Wright Rehabilitation Services
- **Michelle Lutz**
Wright Rehabilitation Services
- **Bo Marlow**
UAW Local 885 (Deceased)
- **Linda McMurray**
Builders Insurance Group
- **Amy McNeal**
St. Paul Travelers
- **Joel Moorehead, M.D., MPH**
Emory University Rollins School of Public Health
- **David Moskowitz, Esq.**
Moskowitz & Carraway
- **Daniel Navarro**
Physiotherapy Associates
- **Curtis Norvell**
The Catera Company
- **Dave O'Donnell**
Caraustar
- **Lynn Olmert, Esq.**
Hollowell, Foster & Gepp
- **R. Briggs Peery, Esq.**
Swift, Currie, McGhee & Hiers
- **Molly Phillips**
Spectrum Managed Care
- **Brenda Hinds Pool**
Georgia State University
- **Aruna Rao-McCann**
Wright Rehabilitation Services
- **Beth Randolph**
Beaulieu of America
- **Brenda Ratcliff**
Shaw Industries
- **Ray Rodriguez**
C. W. Matthews Contracting Co., Inc.
- **Vicki Sadler, CDMS**
Judin & Sadler
- **Scott Smith**
Fleetwood Homes
- **Dina Snyder**
Spherion Corporation
- **Karen Sprouse**
CCI
- **John M. Strain, Esq.**
Davidson & Strain
- **Bob Taylor**
Gwinnett County Public Schools
- **Pamella D. Thomas, M.D., MPH**
Lockheed Aeronautical Systems
- **Bill Vargo**
Nordic Cold Storage, LLC
- **Alex Wallach, Esq.**
George & Wallach
- **Guy L. Watkins, Jr.**
Business Consulting & Investigations
- **Craig E. Weil, M.D.**
The Center for Orthopaedics & Sports Medicine
- **Connie Wilbanks**
Emory University

Continuing Education Credits

Educational credits are offered for the following **CERTIFIED/LICENSED PROFESSIONALS**:

CCM – Certification for Case Managers (13.5 hours)
CRC – Certified Case Managers (13.5 hours)
CDMS – Certified Disability Management Specialist (13.5 hours)
CWAVES – Work Adjustment and Vocational Evaluation Specialist (13.5 hours)
- Must sign roster Monday & Tuesday morning in order to receive your certificate for **10.0** contact hours.
- Must sign roster Wednesday morning in order to receive your certificate for **3.5** contact hours.

AAOHN – American Association of Occupational Health Nurses
RN – Georgia Nurses Association
-Must sign the roster on Monday & Tuesday morning and pick up **ADDITIONAL NURSING EVALUATION FORMS**.
-Must turn in special nursing evaluation forms in order to pick up your certificate for **11.8** contact hours on **TUESDAY AFTERNOON AT 3:30 P.M.**
-Must sign roster Wednesday morning for additional **3.4** contact hours in order to receive your certificate at the end of the Wednesday session. **NO CERTIFICATES WILL BE MAILED.**

LICENSED INSURANCE AGENTS/LICENSED INSURANCE ADJUSTERS
-Must sign roster on Monday & Tuesday morning and **ENTER LICENSE NUMBER** for **13.0** P&C contact hours.
-Must sign roster on Wednesday morning for **3.0** ethic contact hours.
-CREDITS WILL BE ELECTRONICALLY ENTERED. **NO CERTIFICATE WILL BE ISSUED, EXCEPT FOR GENERAL ATTENDANCE CERTIFICATE INCLUDED IN PACKET.**

CLEs – GEORGIA, FLORIDA, SOUTH CAROLINA – CONTINUING LEGAL EDUCATION
-Must sign roster on Monday & Tuesday morning for **10.3** CLE hours (Georgia and South Carolina), **29.0** General Credits (Florida) and **8.3** CLE credits (Alabama).
-Must sign roster on Wednesday morning for **3.0** Ethic CLE hours (Georgia and South Carolina) and **3.0** Ethic CLE hours (Alabama)
-CERTIFICATES WILL ONLY BE ISSUED ON-SITE FOR FLORIDA.

LPCA-GA – Licensed Professional Counselors Association of Georgia
-Must sign roster on Monday & Tuesday morning in order to receive certificate Tuesday afternoon at 3:30 p.m. for **10.0** contact hours.
-Must sign roster on Wednesday morning for **3.0** Ethic contact hours in order to receive certificate Wednesday afternoon.

ABIH- American Board of Industrial Hygiene (CIH/CAIH)
-Must sign roster on Monday & Tuesday morning in order to receive certificate for **2.0** Safety CM points on Tuesday.
-Must sign roster on Wednesday morning for **.5** Safety CM points in order to receive certificate at the end of the Wednesday session.

PHR, SPHR, GPHR – Human Resource Certification Institute (HRCI)
-Must sign roster on Monday & Tuesday morning in order to receive certificate for **10.0** recertification hours on Tuesday.
-Must sign roster on Wednesday morning in order to receive certificate for **3.0** recertification hours on Wednesday.

COURT REPORTERS – Institute of Continuing Judicial Education of Georgia (ICJE)
-Must sign roster on Monday & Tuesday morning in order to receive certificate for **10.5** credit hours on Tuesday.
-Must sign roster on Wednesday morning in order to receive certificate for **3.0** credit hours on Wednesday.

Other professions may be eligible for credits by submitting the **CERTIFICATE OF ATTENDANCE** in your packet along with the program agenda to your certification boards.

Please note that in order to receive the total number of CEUs approved for you must sign the roster **each morning** of the conference. This information **is required** by various certification boards in order to ensure attendance accuracy. Thank you.

CONFERENCE AGENDA

SUNDAY, AUGUST 27, 2006

5:00 – 6:00 p.m. EARLY REGISTRATION & OPENING OF EXHIBITS
6:00 – 7:00 p.m. WINE & CHEESE RECEPTION

GENERAL SESSION

MONDAY, AUGUST 28, 2006

9:00 – 9:05 a.m. WELCOME – Stan Carter, Executive Director, SBWC
9:05 - 9:30 a.m. OPENING REMARKS – Carolyn C. Hall, Chairman, SBWC
Kids' Chance Presentation

MEDICAL SESSION

MONDAY, AUGUST 28, 2006

1:00 – 2:00 p.m.

SURVIVOR BACK TALK CHALLENGE

A lively discussion on living with back pain and treatment alternatives in Workers' Compensation – what is experimental, what works, and what doesn't.

Bryan Barnes, M.D. – Georgia Neurological Surgery
Scott Boden, M.D. – The Emory Spine Center
Judge Steve Fain – SBWC
Bruce Nixon, H.B.Sc, M.D., Ph.D., FRSC, FACS – Specialty Clinics of Georgia
Kimberly Walpert, M.D. – Georgia Neurological Surgery

2:00 – 2:10 p.m.

BREAK

2:10 - 3:30 p.m.

BIGGEST LOSER: WEIGHING IN ON THE CHALLENGES OF RECOVERING FROM LOWER EXTREMITY INJURIES:

How health literacy of workers affect the recovery from lower extremity injuries in the workers with diabetes mellitus and obesity and what can be done to change this trend in medicine.

J.F. Rick Hammesfahr, M.D. – The Center for Orthopaedic and Sports Medicine
Steven Forbush, PT, MS – Physical Therapy Center of University of Central Arkansas
Sandra Elliott – Cobb County School District

TUESDAY, AUGUST 29, 2006

9:00 – 10:00 a.m.

UNSOLVED MYSTERIES: UNRAVELING THE MYSTERIES OF SHOULDER, ARM AND WRIST DISORDERS:

Finding the treatment alternatives and solutions for upper extremity injuries and disorders. Discussion will include the perspective for physicians, employers, and claim adjusters.

Connie Chandler, RN, COHN-S – United Parcel Service
Xavier Duralde, M.D. – Peachtree Orthopaedic Clinic
Waldo Floyd, III, M.D. – Macon Orthopaedic & Hand Center
Mary Justice, SCLA, CWCP – Sedgwick CMS

10:00 – 10:10 a.m.

BREAK

10:10 – 12:00 p.m.

FINDING THE CLUES FOR DETERMINING SUCCESSFUL PAIN MANAGEMENT:

An in-depth discussion about the challenges of determining appropriate treatment options in controversial areas of pain management.

John G. Heller, M.D. – Emory Orthopaedic and Spine Center
Judge David Imahara – SBWC
Matthew Richardson, M.D. – Peachtree Spine Physicians
Mark Ellis, M.D. – Ellis Pain Management
James Weisberg, Ph.D. – Emory Orthopaedic & Spine Center

12:00 – 1:00 p.m.

LUNCH ON YOUR OWN

TUESDAY EVENING – 6:00 11:00 P.M.

DINNER & ENTERTAINMENT

LEGAL SESSION

MONDAY, AUGUST 28, 2006

9:30 – 10:00 a.m.

STATUTORY CASE LAW UPDATE

This topic will cover the new statutory changes implemented by the 2006 Georgia Legislature. It will summarize Board Rule changes as well as provide an update on any workers' compensation case law decisions handed down by the Georgia Court of Appeals and Georgia Supreme Court since August 2005.

Charles L. Spillers, Esq. – Brosnahan, Castan, Lecca & Spillers

10:00 – 10:25 a.m.

EARLY INTERVENTION AND PREVENTIVE MAINTENANCE FOR THE WORKERS' COMPENSATION CLAIM:

How do you prevent the claimant from feeling he/she needs an attorney? What is the best way to get the case ready for litigation? How do you keep a handle on medical costs for your workers' compensation claims? The answers to these questions, and more, will be addressed in this topic designed to assist the employer and insurance claims representative "triage" claims to prevent some of the more common cost escalation problems.

Joe David Jackson, Esq. – Goodman McGuffey Lindsey & Johnson, LLP

10:25 – 10:35 a.m.

BREAK

10:35 – 11:15 a.m.

PLAYING THE NUMBERS...104, 240, 240A & OTHER FORMS:

This topic will be presented in a group format by a defense attorney, claimant's attorney and employer (Human Resources) representative. The topic will cover the common steps employers must follow to bring the injured employee back to light duty work and keep him/her there. It will include a discussion from the employer's perspective to how light duty work can impact the work force and how to avoid any negative reaction from the claimant and/or co-workers. Finally, the general attacks on the return to work process will be discussed from the claimant's point of view highlighting the claimant's fears and concerns in a light duty work setting.

Steven D. Prelutsky, Esq. – Hall, Booth, Smith & Slover, PC

Miles L. Gammage, Esq. – The Gammage Firm

Beth Randolph, CWCP – Beaulieu America Group, LLC

11:15 – 11:35 a.m.

AVOIDING PENALTIES AND ATTORNEY'S FEES:

Once a claim is in litigation, there are a number of "legal mine fields" to avoid. From WC-205's, Rule 102 requirements, to controverting a particular issue in a timely fashion, this topic will alert the employer and insurance representative to some specific danger areas which can and should be avoided. The topic will also highlight time deadlines that must be met. Do not fall prey to these legal traps!

Pierrette H. Jones, Esq. – Drew Eckl & Farnham, LLP

(continued on next page)

TUESDAY, AUGUST 29, 2006

1:00 – 1:30 p.m.

STATUTORY CASE LAW UPDATE

This topic will cover the new statutory changes implemented by the 2006 Georgia Legislature. It will summarize Board Rule changes as well as provide an update on any workers' compensation case law decisions handed down by the Georgia Court of Appeals and Georgia Supreme Court since August 2005.

Douglas T. Lay, Esq. – Kissiah & Lay

1:30 – 2:00 p.m.

CHANGE IN CONDITION VS. NEW INJURY – WHOSE PROBLEM IS IT ANYWAY?

Whether or not an employee has undergone a change in condition for the worse or sustained a new injury, fictional or otherwise, is never very easy to determine. What is a fictional new injury? What are "new circumstances" which can give rise to the finding of a fictional new injury? This topic will update the audience on new developments in this ever changing area of the law.

Todd A. Brooks, Esq. – Swift, Currie, McGhee & Hiers, LLP

2:00 – 2:10 p.m.

BREAK

2:10 – 2:30 p.m.

BRIEF UPDATE ON THE UNDOCUMENTED WORKER SETTING:

This topic has been discussed in past seminars; however, there have been recent case law developments and legislative moves which could impact the undocumented labor force in Georgia. A brief update on what is happening in this regard will be covered including a recent decision made by the Georgia Court of Appeals which should garner some interest amongst all employers in this state. Michael Kessler, Esq., who will speak on this topic, is the defense attorney who argues the case of *Martinez v. Worley & Sons Construction* in which the Georgia Court of Appeals suspended benefits when the employee did not return to work contingent upon being able to show proper documentation of legal status in the country to work.

Michael A. Kessler, Esq. – Attorney at Law

2:30 – 3:30 p.m.

INDOOR AIR POLLUTION: WHAT IS YOUR EXPOSURE:

This topic will be presented in a panel format by speakers with expertise in indoor air pollution, medical diagnosis, treatment and litigation of claims. The topic will provide an overview of indoor air pollution by covering known indoor air pollutants, how to diagnose/investigate an indoor air pollution claim with appropriate corrective measures, medical management of employees, and a legal update on the legal aspect of such claims.

Brenda Hinds Pool, MSPH, CIH – Georgia State University

V. Ramana Dhara, MD, ScD, MPH – International Health Consulting Group

C. Wade McGuffey, Jr. Esq. – Goodman McGuffey Lindsey & Johnson, LLP

TUESDAY EVENING – 6:00 11:00 P.M.

DINNER & ENTERTAINMENT

LEGAL SESSION

(continued from previous page)

MONDAY, AUGUST 28, 2006

11:30 – 12:00 p.m.

LEGAL ROULETTE:

This will be a panel format topic presentation. The moderator will submit questions for each panel member. There will be a claimant's attorney, defense attorney, and State Board of Workers' Compensation judge on the panel. Questions will be on recent legal decisions and topics in the workers' compensation arena. The moderator will open the floor to the audience so they too can ask questions of our expert panel member on whatever pressing issues they have in the workers' compensation field.

Judge Rick Thompson – SBWC
J. Franklin Burns, Esq. – Attorney at Law
Kevin B. Carlock, Esq. – Moore Ingram Johnson & Steele

MULTI-STATE BREAKOUT

MONDAY, AUGUST 28, 2006

9:00 – 12:00 p.m.

10:25 – 10:35 p.m.

BREAK

MULTI-STATE WORKERS' COMPENSATION BREAKOUT:

Florida, South Carolina and Alabama. Gone are the days when all claims are adjusted locally. No need to travel far afield to learn the general parameters of Workers' Compensation Rules & Regulations in our sister/border states. Discussion of the workers' compensation laws and rules of the covered states will be provided by lawyers from each state. These legal experts will cover, among other things, how each state deals with burden of proof issues, medical issues, catastrophic injuries, drug defenses and much, much more.

James N. McConaughay, Esq. – McConaughay, Duffy, Coonrod, Pope & Weaver, P.A.

Theodore N. Goldstein, Esq. – Rissman, Barrett, Hurt, Donahue & McClain, P.A.

Thomas S. Thornton, Esq. – Carr, Allison

R. Mark Davis, Esq. – McAngus, Goudelock & Courie, LLC

TUESDAY, AUGUST 29, 2006

1:00 - 3:30 p.m.

2:00 – 2:10 p.m.

BREAK

MULTI-STATE WORKERS' COMPENSATION BREAKOUT:

Florida, South Carolina and Alabama. Gone are the days when all claims are adjusted locally. No need to travel far afield to learn the general parameters of Workers' Compensation Rules & Regulations in our sister/border states. Discussion of the workers' compensation laws and rules of the covered states will be provided by lawyers from each state. These legal experts will cover, among other things, how each state deals with burden of proof issues, medical issues, catastrophic injuries, drug defenses and much, much more.

James N. McConaughay, Esq. – McConaughay, Duffy, Coonrod, Pope & Weaver, P.A.

Theodore N. Goldstein, Esq. – Rissman, Barrett, Hurt, Donahue & McClain, P.A.

Thomas S. Thornton, Esq. – Carr, Allison

R. Mark Davis, Esq. – McAngus, Goudelock & Courie, LLC

TUESDAY EVENING – 6:00 11:00 P.M.

DINNER & ENTERTAINMENT

INSURANCE/SELF-INSURANCE SESSION

MONDAY, AUGUST 28, 2006

1:00 - 2:00 p.m.

**MEDICAL PEER REVIEW UNDER THE
GEORGIA WC STATUS 203-B:**

This discussion will include the appropriate timing for a peer review, types of cases to submit, and whether or not pre-certification is needed:

Mitchell S. Nudelman, M.D., J.D., FCLM Medical Director
Solutions, LLC

2:00 - 2:10 p.m.

BREAK

2:10 - 3:30 p.m.

MEDICARE SET ASIDE AND PHARMACY UPDATE:

This topic will provide the attendees with information regarding MSA requirements as well as Medicare's new pharmacy policy and the overall impact to the claim settlement process.

Laurence L. Christensen, Esq. – Attorney at Law

TUESDAY, AUGUST 29, 2006

9:00 - 10:00 a.m.

**BUILDING A PARTNERSHIP BETWEEN
THE EMPLOYER AND ADJUSTER:**

This topic will include a panel that will focus on the roles and responsibilities of each party to the claim handling process. Information that needs to be gathered to adjudicate a claim, panel of physician list, wage statements and ongoing communication throughout the life of the claim.

Gladys Briggs – G. Briggs & Associates, Inc.
William R. Johnson, Esq. – Moore, Ingram, Johnson & Steele
Bruce Moseley – Builders Insurance Group, Inc.

10:00 - 10:10 a.m.

BREAK

10:10 - 12:00 p.m.

**WORKERS' COMPENSATION FRAUD: HOW
TO SPOT IT AND PREVENT IT:**

This discussion is designed to assist in the identification and investigation of potentially fraudulent issues.

Daniel C. Kniffen, Esq. – Drew Eckl & Farnham, LLP

12:00 - 1:00 p.m.

LUNCH ON YOUR OWN

CASE MANAGEMENT & DISABILITY SESSION

MONDAY, AUGUST 28, 2006

9:30 - 10:25 a.m.

A CASE MANAGEMENT INTERACTIVE SESSION:

Interactive discussion concerning case management scenarios. Every discipline of case management will be represented. Participants will discuss factors in making decisions that affect outcomes of case management. Case scenarios will be discussed in small groups. Case Managers, Physicians, Attorneys, Employers and Claims Adjusters will be present at both sessions, so all disciplines will interact and the outcomes will be realistic. DOOR PRIZES WILL BE GIVEN!

Kenneth J. Kress, M.D. – Resurgens Orthopedics
John Gleason, M.D. – Resurgens Orthopaedics
Robert A. Kelly, M.D. – Resurgens Orthopaedics
Vinson Smith, M.D. – Sutton Orthopaedics & Sports Medicine
James Eilner, M.D. – Georgia Pain Management and Samson Pain Center
Jeffrey Wainstein, M.D. – Concentra Health Services
D. Hal Silcox, III, M.D. – Peachtree Orthopaedic Clinic
Jane T. St. Clair, M.D., MPH – Wellbeings Occupational Healthcare
Barry J. McClasland, M.D. – Neurologist
Dennis Doherty, M.D. – Southeastern Pain Specialists
Stephen McCollam, M.D. – Peachtree Orthopaedic Clinic
J. Kevin Brooks, M.D. – Southern Orthopaedic & Sports Medicine

10:25 - 10:35 a.m.

BREAK

10:35 - 12:00 p.m.

A CASE MANAGEMENT INTERACTIVE SESSION:

A continuation from previous session.

12:00 - 1:00 p.m.

LUNCH ON YOUR OWN

TUESDAY, AUGUST 29, 2006

1:00 - 2:00 p.m.

**WHEN A TOTAL KNEE REPLACEMENT IS NOT
WORKERS' COMPENSATION:**

Dr. Kress will discuss diagnoses that lead to Total Knee Replacements, which are compensable and which are not. He will also discuss the diagnosis, types of treatments, surgery and rehabilitation of patients who have required a knee replacement.

Kenneth J. Kress, M.D. – Resurgens Orthopedics

2:00 - 2:10 p.m.

BREAK

2:10 - 2:30 p.m.

**WHAT'S NEW WITH COMPLEX REGIONAL
PAIN SYNDROME:**

Dr. Tom Runyan will give us an update of Complex Regional Pain Syndrome. He will discuss the physical manifestations and testing options (new and old), to support and confirm the diagnosis and the grading system. He will explain why we are seeing more of it than ever before.

Thomas Runyan, M.D. – Consultants in Pain Medicine

TUESDAY EVENING - 6:00 11:00 P.M.

DINNER & ENTERTAINMENT

ETHICAL CONSIDERATIONS in WORKERS' COMPENSATION

WEDNESDAY, AUGUST 30, 2006

9:00 a.m. – 9:15 a.m.

OPENING REMARKS

Judge Carolyn C. Hall, Chairman, State Board of Workers' Compensation

9:15 a.m. – 10:00 a.m.

ETHICS FOR CLAIMS PROFESSIONALS: BEST PRACTICES FOR WORKERS' COMPENSATION ADJUSTERS:

A panel discussion on the best practices for Workers' Compensation Adjusters & Ethics for Claims Professionals.

John A. Ferguson, Esq. – Drew Eckl & Farnham, LLP
John H. Ross – C.W. Matthews Contracting Company, Inc.
Cindy Youlton – ESIS

10:00 – 10:15 a.m.

BREAK

10:15 – 11:00 a.m.

ETHICS IN MEDICAL EVIDENCE:

A panel discussion on the use of common sense and fairness in the submission of medical evidence and how it corresponds directly to the actual versus perceived results.

H. Michael Bagley, Esq. – Drew Eckl & Farnham, LLP
Miles L. Gammage, Esq. – The Gammage Firm
Brenda Moore – Association County Commissioners of GA
Steve Shindell, Ph.D. – Georgia Neuropsychology, LLC

11:00 – 12:30 p.m.

KEYNOTE ADDRESS

PROFESSIONALIZING THE RETURN-TO WORK PROCESS: AN ETHICAL APPROACH:

In these days of constant change and crisis, workers' compensation professionals must look to its managers and supervisors and executive staff to provide not only leadership but also a sense of security, both emotional and physical, for its employees. Mr. Pimentel will explore how best practice organizations have professionalized their Return to Work process while dealing with constant change.

Richard Pimentel – Milt Wright & Associates, Inc.

CLOSING REMARKS

Judge Carolyn C. Hall

GRAND PRIZE DRAWING

Featuring...KEYNOTE SPEAKER



Richard Pimentel

Milt, Wright & Associates

Richard Pimentel is a Senior Partner of Milt Wright & Associates, Inc. He is a nationally renowned expert on disability management, workers' compensation cost containment, rehabilitation, and job retention in the workplace. His vast and penetrating knowledge about issues related to disability and people of difference is communicated with humor and conviction. As a consultant, keynote speaker, professional trainer and author of numerous curricula and training guides, Richard Pimentel is distinguished by his unerring ability to predict and anticipate the needs and requirements of both public and private sector employers. Be sure to attend this entertaining presentation as Mr. Pimentel discusses The Ethical Approach in the Return to Work Process.

PRIZES! PRIZES! PRIZES! PRIZES!

EXHIBITOR DOOR PRIZES DRAWING

To be held on Wednesday morning at 10:45 a.m..

Prizes can be picked up at the Exhibit Booth during the mid-morning break.

General Attendance Door Prize Drawing

Will be held on **Wednesday** at the end of the conference.
You do not have to be present to win.

\$300.00
Gift Certificate
to
BP Gas

Wednesday Attendees Only Special Drawing

Will be held at the end of the conference.
You DO have to be present to win.

\$150.00
Gift Certificate
from
Home Depot

Tuesday Night!

6:00 p.m. - 7:00 p.m.

Dinner

7:00 p.m. - 11:00 p.m.

Show and Dance



Featuring...

LIQUID PLEASURE

with Kenny Mann



DINNER & DANCE GO-SPONSOR

Corporate Pharmacy Services

PO BOX 120
100 Whitlock Avenue • Suite 320
Marietta, Georgia 30064
770-429-8043
www.corporatepharmacy.com



Special Thanks

to Our Coffee Break and Reception Sponsors

- ❖ AIM Disability Management & Consulting
 - ❖ American Insurance Association
 - ❖ Comprehensive Orthopaedic Group
 - ❖ Concentra
 - ❖ Georgia Hand & Microsurgery
 - ❖ Georgia State AFL-CIO
 - ❖ GSIA
 - ❖ Johnson & Associates
 - ❖ Medical Technologies Unlimited
 - ❖ Modern Medical
 - ❖ Prime Care Infusion
 - ❖ Self-Insurance Administrators, Inc.
- 
- 

ABILITY SERVICES NETWORK INC. #69

2905 PREMIERE PARKWAY, STE. A
DULUTH, GA 30097
770-622-7295
www.abilityservicesnetwork.com

ASN is an independent, national provider of total wellness, case management, and cost containment services within the work place and disability market. Our unique proactive employee health and an overall reduction of illness, injury, and lost time from work.

ACADEMY ORTHOPEDICS, LLC #42

318 TRIBBLE GAP ROAD
CUMMING, GA 30040
770-889-0891
www.academyorthopedics.com

Providing comprehensive care of the musculoskeletal system, pain management services & Ambulatory Surgery Center, Academy Orthopedics specializes in quality orthopedic care. Our physicians (Michael J. Kalsen, MD, FAAOS, Jesse Seidman, MD, FAAOS, and Jay Bender, MD, ABPMR) understand the importance of communication between doctors, employers and insurance carriers. They offer their expertise as panel physicians to a wide variety of local businesses, providing cost effective treatment to return employees to full work status in a timely manner. We are located in Duluth, Sugar Hill, and Cumming, Georgia. For additional information, contact our Worker's Compensation Manager, Sheila Howington, at 770-217-0881, Email: showington@academyorthopedics.com

AccessOnTime #81

3210 LAKE EMMA ROAD
STE. 3090
LAKE MARY, FL 32746
888-748-7575

www.accessontime.com

Access Transport Services Holding, Inc. dba AccessOnTime has, since 1998, provided non-emergency medical transportation and language services nationwide to worker's compensation claimants, as authorized by our customers who are primarily workers' compensation insurance carriers, third-party administrators, service providers, adjusters, and caseworkers; achieved through our network of credentialed independent contractors.

ACCESSIBILITY SERVICES #94 & 95 PLAZA

1310 KENNESTONE CIRCLE
MARIETTA, GA 30066
678-819-7583

www.rehab-plaza.com

Accessibility Services Plaza is a modern rehabilitation products retail facility located in Marietta, Georgia. Combining many of the products and services typically required by individuals with disabilities, the Plaza offers several of the Southeast regions premiere service companies under one roof. They include All In One Accessibility (home accessibility equipment and home renovation), Handicapped Driver Services (vehicle sales, service and modification), On The Go Medical (rehab and DME products) and Paraquad Nursing Services (at home nursing care and senior care).

ACE MEDICAL TRANSPORT & TRANSLATION #55

PO BOX 921755
NORCROSS, GA 30010-1755
678-969-0007

Ace Medical is the leader in non-emergency and wheelchair transport serving the entire nation and providing language services in over 150 languages. acemed1@bellsouth.net

ADVANCED BIONICS CORPORATION #98

25129 RYE CANYON LOOP
VALENCIA, CA 91355
661-362-1400

www.advancedbionics.com

Advanced Bionics is the manufacturer of the first fully rechargeable and smallest neuro-modulation device to treat common pain of the trunk and limbs.

ADVANTAGE SURVEILLANCE, INC. #52

PO BOX 788
THOMASVILLE, NC 27360
888-696-3669

www.advantagesurveillance.net

Now with a local office in Marietta, Georgia and the contact of Area Manager / Reggie Walker 888.696.3669 ext. 302. Advantage Surveillance is known throughout the southeast for consistently providing high quality, results-oriented investigative services. We value our reputation as an agency that makes every effort to acquire the results our Clients expect. Our commitment is unmatched and our results are superior!

ALBORS ALNET LANGUAGE & TRANSPORTATION SERVICES #106

5971 BRICK COURT, STE. 200
WINTER PARK, FL 32792
www.alborsalnet.com

Albors Language Services and Alnet Transportation have been providing timely and cost effective solutions in translations, interpretations and transportation to the Workers' Compensation industry for over 20 years. Alnet transportation provides nationwide non-emergency ambulatory, wheelchair and stretcher services. Language services include telephonic or on-site interpretations, translation of documents, recorded statements and stipulations of settlement.

ALIGN NETWORKS #102

11655 CENTRAL PARKWAY, STE. 306
JACKSONVILLE, FL 32224
904-998-0211

www.alignnetworks.com

Align Networks is the nation's premier outpatient rehabilitation network specializing in Workers' Compensation care. The Align program focuses on timely scheduling and communication of patient activity to all parties involved in the case. The end result is superior outcomes, bottom line savings, and a personalized service that is unique in the industry today.

APEX INVESTIGATIONS & RESEARCH, INC. #7

6805 MABLETON PARKWAY
MABLETON, GA 30126
770-732-8612

www.apexinvestigators.com

Apex Investigations is a full service private investigations firm specializing in workers' compensation fraud. Our other services include but are not limited to surveillance/undercover operations, pre-hire screenings, locates & theft. All of our lead investigators are ex-law enforcement officers that are highly trained. Apex also has a bi-lingual investigator. www.apexinvestigators.com

ATLANTA NEUROLOGICAL & SPINE INSTITUTE #112

285 BOULEVARD N.E., STE. 110
ATLANTA, GA 30312
404-265-6701

www.spine-specialists.com

Atlanta Neurological & Spine Institute, LLC, focuses on non-operative treatment for adult spine disorders. Our main office is located conveniently in Downtown Atlanta, with satellite offices in Marietta and Gwinnett. For patients requiring a higher level of care, doctors use minimally invasive endoscopic techniques. There is a current trend towards minimally invasive surgery. We provide back solutions using new technology, combining a blend of video technology, laparoscopic techniques and traditional spinal surgery. We also use therapies and modalities based on techniques designed initially to treat high performance athletes and to successfully treat back and neck pain.

ATLANTA SPINE INSTITUTE #25

3200 DOWNWOOD CIRCLE, STE. 500
ATLANTA, GA 30327
404-352-4500 EXT. 624

www.atlantaspine.com

The Atlanta Spine Institute specializes in the use of cutting-edge minimally invasive techniques and methods to perform adult reconstructive procedures for the correcting of cervical and lumbar spine disorders. Minimal access spinal technologies make possible the treatment of herniated discs and other spinal disorders in a manner that is much less invasive.

ATLANTA SPINE SPECIALISTS #44

753 OLD NORCROSS ROAD, STE. B
LAWRENCEVILLE, GA 30045
770-236-8884

care@spine-ology.com

Atlanta Spine Specialists is committed to the diagnosis and treatment of back pain by non-operative minimally invasive diagnosis and treatment protocols. Treatment is systematic with clear treatment goals and a dedication to reaching return to work and maximum medical improvement in a timely fashion.

ATLANTA SPORTS MEDICINE & ORTHOPAEDIC CENTER #72

3200 DOWNWOOD CIRCLE, STE. 500
ATLANTA, GA 30327

www.atlantasportsmedicine.com/www.atlantasportsmedicine.net

The physicians and staff of the Atlanta Sports Medicine and Orthopaedic Center: (Drs. Gillogly, Hyman, Myers, Negrin, Garten) look forward to exceeding your expectations in serving your WC needs. These Team physicians for the Atlanta Falcons and Atlanta Thrashers also offer first rate care for your workers and first class service for you.

ATLANTIC IMAGING GROUP #80

2 RIDGEDALE AVENUE, STE. A-10
CEDAR KNOLLS, NJ 07927
973-451-8233

www.aignetnetwork.com

Atlantic Imaging Group is a diagnostic radiology network company who services the workers compensation and liability insurance industries.

ATRIUM IMAGING GROUP #38

871 JOE FRANK HARRIS PARKWAY
CARTERSVILLE, GA 30120
678-721-9700

www.atriumimaginggroup.com

Atrium Imaging Group is a family of imaging facilities that provides progressive and innovative healthcare services for your injured worker. Embracing superior patient care by providing physicians, case managers and adjusters with state of the art open MRI and CT technology. In addition to our Cartersville location, we also have offices in Dalton, GA (706) 277-0700 and Snellville, GA (678) 344-5570.

AWPRX #86

160 N. Westmonte Drive
Altamonte Springs, FL 32714
800-600-1930

www.aprx.com

AWPRX is a pharmacy benefit manager that provides services exclusively to the workers compensation market. Workers Compensation is unique and requires information management that no PBM, except AWPRX can provide. Come to our booth to see how we can save you superior savings and control.

BENCHMARK PHYSICAL THERAPY #3

8823 PRODUCTION LANE
OOLTEWAH, TN 37363
423-238-7217

www.benchmarkpt.com

Opened since 1995, BenchMark Physical Therapy is an outpatient provider, privately owned company with over 50 clinics to serve you in Southeast TN, North Georgia and North Carolina. BenchMark offers PT, OT and Speech and has multiple specialty programs to include: Aquatics, Neuro/Vestibular, Lymphedema, Osteoporosis, Fibromyalgia, and Workers' Compensation.

BLACK DIAMOND SERVICES #104

PO BOX 23458
FT. LAUDERDALE, FL 33307
954-786-2021

www.blackdiamond.org

Black Diamond Transportation & Language Services is the leader in arranging quality services at competitive rates Nationwide! We strive to give you peace of mind! Our Language Services has over 200 different dialects and languages including American Sign Language. To experience the "GEM" of the transportation & language services industry, please contact us at 800-685-4789 or visit our easy and secure website: www.blackdiamond.org

BRENTWOOD SERVICES #92
104 CONTINENTAL PLACE, STE. 200
BRENTWOOD, TN 37027
615-263-1300

Brentwood Services is an independent employee-owned TPA/Excess Broker that specializes in structuring and managing alternative market solutions for workers' compensation. A regional company with national capabilities, we draw upon our in-depth local expertise, access to national and global markets, and proven experience to control the costs of workers' compensation. We built our reputation on and are committed to the principles of integrity, honesty, and transparency in serving the best interests of our clients.

CADUCEUS OCCUPATIONAL MEDICINE #79
535 N. CENTRAL AVENUE
HAPEVILLE, GA 30354
404-761-4040

www.caduceus24-7.com
Caduceus Occupational Medicine is a multi-site Occupational Medicine practice founded in April, 1999. Caduceus has grown to six locations, with 24/7 medical services offered at our Midtown Clinic staffed with a provider and medical assistant. Caduceus owner, Dr. Stephen Dawkins, is pleased to announce the availability of a mobile unit equipped to service occupational/workers' comp needs on-site and in remote locations. Caduceus has distinguished itself among Occupational Medicine providers through: high quality medical care, exemplary customer service, 24/7 availability, and ease of physician access.

CAREMASTER MEDICAL SERVICES #16
240 O'DELL ROAD
PO BOX 278
GRIFFIN, GA 30224
770-227-1264

www.caremastermedical.com
Caremaster is a homecare provider covering all of Georgia and Eastern Alabama. Services include: Skilled and Unskilled nursing (4-24hr/7days), I.V. Therapy, CCSP, ICW, Hospice and Medical Supplies. Caremaster specializes in SCI and TBI and neurological deficit catastrophic cases. The Caremaster Advantage: Convenience, Savings, Quality - it's just what you've been looking for. We're bringing new meaning to the word "home."

CARLISLE MEDICAL, INC. #47
501 BOULEVARD PARK EAST
MOBILE, AL 36609
800-553-1786

www.carlislemedical.com
Carlisle Medical has over 25 years experience as a leader in the workers' compensation industry. Our nationwide pharmacy and durable medical equipment management programs have assisted insurance carriers, third party administrators and employers in significantly lowering their workers' compensation costs. Carlisle provides quality services to the injured worker while presenting significant savings to the employers.

CASE MANAGEMENT SOLUTIONS #50
3500 PARKWAY LANE, STE. 430
NORCROSS, GA 30092
770-840-1164

www.casemgtsol.com
Case Management Solutions provides managed care cost containment services to our nationwide market of self insured employers, insurance carriers, third party administrators and public entities. Our services are focused on the reduction of health care costs, disability benefits, litigation costs and vocational rehabilitation.

CENTENNIAL INVESTIGATIONS #32
2814 SPRING ROAD, STE. 109
ATLANTA, GA 30339
770-438-9200

www.centennialis.com
Centennial is a full-service investigation company specializing in insurance related investigations. We can handle all insurance related needs from determining compensability to surveillance. Our investigators cover the Southeastern United States. Stop by our booth and ask about our \$475 daily flat rate for surveillance.

CENTER FOR COMPREHENSIVE SERVICES - A PARTNER OF MENTOR ABI #71
2411 CLEMENT ROAD
LUTZ, FL 33549
800-203-5394

MENTOR ABI (Acquired Brain Injury) is a member of the MENTOR Network, an organization of shared values and resources offering those who work with us and those we serve the benefits of a strong national structure. Since our founding, we have never waived from our goals of "Building Relationships. Enhancing Lives".

CHOICE CARE OCCUPATIONAL MEDICINE & ORTHOPAEDICS #1
791 OAK STREET
HAPEVILLE, GA 30354
404-601-2000

Choice Care Occupational Medicine & Orthopaedics provides a full range of Occupational medicine service and Substance abuse testing in a timely and accurate matter. We offer 24 hour service and back injury prevention and so much more. We help make your workplace a safe one.

CLAIMS VERIFICATION, INC. #48
1166 W. NEWPORT CENTER DR., STE. 212
DEERFIELD BEACH, FL 33442
888-284-2000

www.cvi.com
CVI is a full service investigations firm providing SIU Services, Claims Investigations, Accident Investigations and Surveillance nationwide. For nearly thirty years, CVI has partnered with the insurance industry in the fight against fraud. Our Southeast Regional office is located in Alpharetta, GA.

CONCENTRA MEDICAL CENTERS #114
5730 GLENRIDGE DRIVE, STE. 308
ATLANTA, GA 30328
404-686-0738

www.concentra.com
Concentra Medical Centers is the largest occupational health provider in the U.S. specializing in workers' compensation with 250+ clinics, 13 in Georgia. We partner with employers and payers to improve outcomes while reducing claims costs by focusing on return-to-work and building long-term relationships with our customers.

CONSERVCARE, INC. #61
1180 CELEBRATION BOULEVARD, STE. 102
CELEBRATION, FL 34747
800-999-5182

www.conservcare.net
A national ancillary products and services provider for the worker's compensation industry. We specialize in coordinating and providing home health, nursing, DME, orthotics, prosthetics, bracing, specialty items, pharmacy programs, home modifications, van conversions, transportation, and diagnostics for your claimants/patients. Any medically necessary product or service, with one phone call - WE DO ALL!

CONSULTANTS IN PAIN MEDICINE, LLC #35
3221 GLYNN AVENUE
BRUNSWICK, GA 31522
912-466-9111

www.docpain.com
Consultants in Pain Medicine provides physician services to workman compensation professionals and patients. Patient evaluation and treatment by Board Certified Pain Management physicians is our core business. We also provide a number of ancillary services such as case reviews to assist in the care of the injured worker. Stop by our exhibit to see if CPM can help with your next case.

CORVEL #99
10700 ABBOTTS BRIDGE ROAD, STE. 110
DULUTH, GA 30097
678-942-7300

www.corvel.com
CorVel Corporation is a national provider of leading-edge managed care service and solutions in the field of managed healthcare. CorVel applies online communications, a national office network and advanced information technology to improve the management of healthcare in the workers' compensation, group health, auto and disability markets. For more information, please call us at (678) 942-7300 or visit us online at www.corvel.com.

CORPORATE PHARMACY SERVICES #107
PO BOX 120
1000 WHITLOCK AVENUE, STE. 320
MARIETTA, GA 30064
770-429-8043

www.corporatepharmacy.com
Find out what the other PBM's don't want you to know! Cost Plus Pricing! NO AWP's or State Fee Schedules. CPS is a Pharmacy Benefits Management company with over 50,000 network pharmacies for short term and first fills, mail order, specialty pharmacy, DME, life care planning and Medicare set-asides.

CRAWFORD & COMPANY #87
5620 GLENRIDGE DRIVE, NE
ATLANTA, GA 30342
404-847-4059

Based in Atlanta, Georgia, Crawford & Company is the world's largest independent provider of claims management solutions to insurance companies, and self-insured entities, with a global network of more than 700 offices in 63 countries. Major service lines include property and casualty claims management, integrated claims and medical management for workers' compensation, legal settlement administration, including class action and warranty inspections, and risk management information services.

CYPRESS CARE #27
2736 MEADOW CHURCH ROAD, STE. 300
DULUTH, GA 30097
678-730-1002

Cypress Care is the standard in Workers' Compensation Pharmacy Benefit Management and Durable Medical Equipment. Cypress Care offers Rehabilitation Equipment, Services and Support: Bone Growth Stimulators/Spinal Stimulators, Orthotics & Prosthetics, Licensed Rehabilitation Services, Diagnostic MRI/FCE Supplier Network, and Continuing Education Programs.

DAVID H. MCCORD, MD, PC #5
PO BOX 331109
NASHVILLE, TN 37203-7510
615-329-0333

Established spine program since 1991 focusing exclusively on spine related issues. We specialize in difficult failed-back, and catastrophic cases, working closely with the Georgia workcomp system offering excellent consistent results. Our goal is to reduce cost and return your clients back into the work force.

DEPUY SPINE-A JOHNSON & JOHNSON COMPANY #20
325 PARAMOUNT DRIVE
RAYNHAM, MA 02767
800-227-6633

www.depuysspine.com
For over 20 years, DePuy Spine, a Johnson & Johnson company, has partnered with leading clinicians, researchers and thought leaders to improve patient care. Today, we remain a leader in the worldwide spine market with an impressive product portfolio, industry-leading education programs, and clinical research to support our work.

DOMINION DIAGNOSTICS #93
211 CIRCUI DRIVE
NORTH KINGSTOWN, RI 02852
401-667-0800/877-734-9600

www.dominiondiagnostics.com
Dominion Diagnostics is a CAP and CLIA certified laboratory that offers clinical quantitative urine drug testing to support your practice regarding prescription compliance and illicit drug usage. Dominion provides technical support, data management, third-party insurance billing, training/education, and research and development. Dominion's quality laboratory solutions enhance outcomes in Pain Management

EMORY EASTSIDE MEDICAL CENTER #82

1700 MEDICAL WAY
SNELLVILLE, GA 30078
770-979-0200
www.emoryeastside.com
Emory Eastside Medical Center has specialty services for the workplace injury. Eastside Pain Center and Inpatient Rehabilitation provide solutions for complex/persistent pain, and a multi-disciplinary approach to rehabilitation for the neurological/orthopedic patient. These specialized physicians, nurses and therapists have the skills and training producing results/assuring a speedy return to work.

EXPRESS DENTAL CARE #15

1211 N. WESTSHORE BOULEVARD
STE. 501
TAMPA, FL 33607
813-281-0810
rmarburger@expresshealthservices.com
Express Dental is the first and only dental network designed to address the special needs of the workers compensation and auto/general liability claims industries. Through our NATIONAL network we coordinate superior dental services for self-insured employers, insurance carriers, managed care organizations, third party administrators, and other claims professionals.

FIRST ADVANTAGE INVESTIGATIVE COMPANY #78

100 CARILLON PARKWAY
ST. PETERSBURG, FL 33716
888-898-0080
www.fadv.com/investigative
First Advantage Investigative Services is a nationwide investigation firm specializing in the detection and exposure of insurance fraud. To find out how you can improve your risk management strategy, call us at 888-898-0080 or visit www.FADV.com/Investigative.

FIRST HEALTH PRIORITY SERVICES #67

21300 VICTORY BOULEVARD, 12TH FLOOR
WOODLAND HILLS, CA 91367
888-987-2667
www.firsthealthps.com
First Health Priority Services is your solution for the Medicare Set-Aside (MSA) and Future Medical Cost Projection process. With over a decade of experience reviewing Workers' Compensation claims for medical necessity and future medical projections, we will determine the need for an MSA allocation, compute the amount of the allocation and obtain Medicare approval of the MSA.

FITNESS FORUM PHYSICAL THERAPY #59

550 PEACHTREE STREET, STE. 1820
ATLANTA, GA 30308
404-589-1800
www.fitness-forum.com
Fitness Forum Physical Therapy and Preventative Medicine has been providing Georgia physical/occupational therapy services since 2001. We offer orthopedic, spine and occupational rehabilitation, Certified Hand Therapy, work conditioning, Certified Blankenship Functional Capacity Evaluations and AMA Impairment Ratings. We have locations in Cumming, North Atlanta, Midtown Atlanta and Columbus, GA.

FLOYD MEDICAL CENTER #64

304 TURNER MCCALL BOULEVARD
ROME, GA 30165
706-509-3400
www.floyd.org
Floyd Medical Center Rehabilitation Services offers a broad spectrum of services ranging from inpatient Rehab to outpatient services. Including but not limited to neurologic, orthopedic, and Occupational Rehab, as well as occupational health services. Our Rehab facility offers treatment from admission of a patient to an inpatient setting through recovery in an outpatient setting.

GENEX SERVICES, INC. #4

5255 TRIANGLE PARKWAY, STE. 100
NORCROSS, GA 30092
770-582-9292 EXT. 3311
www.genexservices.com
GENEX offers comprehensive integrated care solutions which include telephonic case management, field-based medical and vocational case management, utilization review, medical review services, IME's, short/long-term disability case management, medical set-asides, and social security representation. GENEX provides services nationally and also in Puerto Rico and Canada.

GEORGIA1ST.COM #34

1405 SE 1ST STREET
FORT LAUDERDALE, FL 33301
954-980-8611
www.georgia1st.com
Georgia1st.com is a workers' compensation networking resource. The publication is published quarterly and reports on people, places and events associated with workers' comp, including Kids' Chance. The web site provides news and resource information with links to numerous service providers. Advertising rates and deadline information is available by calling 954-980-8611 or e-mailing to info@georgia1st.com.

GEORGIA PAIN MANAGEMENT #2

120 STONE BRIDGE PARKWAY, STE. 420
WOODSTOCK, GA 30189
770-544-1000
www.gapain.com
James Ellner, M.D., Medical Director, of Ga. Pain Management and Samson Pain Center, offers a full range of procedures for acute and chronic pain. Having the licensed and accredited pain center on site allows Dr. Ellner to diagnose and treat patients the same day.

GEORGIA PAIN PHYSICIANS, PC #10

2550 WINDY HILL ROAD, STE. 215
MARIETTA, GA 30067
770-850-8464
www.gegiapainphysicians.com
Georgia Pain Physicians, PC, under the guidance of Robert E. Windsor, MD is a nationally recognized pain management practice. Our core philosophy and belief system requires that we provide service-oriented medical care to patients suffering from acute and chronic pain. We provide this care in an atmosphere of respect and compassion while utilizing a dynamic combination of medical treatment options to reduce pain and improve function. Robert E. Windsor, MD and Georgia Pain Physicians, PC provides a full range of treatments and procedures supported by over 20 years of clinical experience, research and education.

GEORGIA PROSTHETICS #43

398 14TH STREET, NW
ATLANTA, GA 30318
404-873-3725
Georgia Prosthetics has been providing clinical excellence in prosthetics limbs in Atlanta since 1963. They have over 70 years of combined clinical experience in formulating and implementing treatment plans for individuals who have suffered the loss of one or more extremities utilizing technology that is appropriate to the defined treatment goals for each individual. Georgia Prosthetics specializes in clinically challenging cases that are complicated by co-morbidities, traumatic injuries, and difficult amputation levels such as hip disarticulations and partial hands.

GLOBAL TRANS SERVICES, INC. #26

4470 CHAMBLEE DUNWOODY ROAD,
STE. 451
ATLANTA, GA 30338
770-465-8065/866-648-7264
www.globaltransservices.com
Global Trans Services, Inc. is the premier provider of reliable non-emergency medical transportation and interpretation services. Global Trans Services serves the Workers' Compensation and Personal Injury Industry throughout the nation. At GTS, we specialize in providing certified interpreters and translators in over 150 languages and dialects for all medical and legal appointments. We pride ourselves in our true commitment to service. Client satisfaction, via personal attention, is priority one. Trust GTS, we will do whatever it takes to get the results you deserve.

GOULD & LAMB, LLC #89

3526 9TH STREET WEST
BRANDENTON, FL 34205
941-798-2098
As a cost containment company and the nation's premier Medicare Set-Aside vendor, Gould & Lamb is known throughout the industry for producing the most accurate, reliable, and defensible MSA reports. Through our unique combination of healthcare, insurance, legal and financial professionals, Gould & Lamb is here to protect your interests.

GWINNETT NEUROSURGICAL-GWINNETT SPINE, PC #45

753 OLD NORCROSS ROAD, STE. A
LAWRENCEVILLE, GA 30045
770-995-5333
www.gwinnettspine.com
Dr. Penney is a neurosurgeon that specializes in the treatment of head, lumbar, cervical and spinal cord injuries. He also treats cases such as carpal tunnel syndrome. His primary treatment plan consists of surgery, however, we do offer conservative treatment as well.

GWINNETT SPORTS REHAB #14

500 MEDICAL CENTER BOULEVARD,
STE. 130
LAWRENCEVILLE, GA 30045
678-442-2803
www.gwinnettmedicalcenter.org
Our highly-qualified staff of licensed physical and occupational therapists offer comprehensive assessment and treatment of work-related injuries. Services include physical therapy, hand therapy (CHTs) and FCEs. Our clinics are located in Duluth and Lawrenceville. Gwinnett SportsRehab is an affiliate of Gwinnett Medical Center.

HOMENURSE, INC. #28

2920 NORTH EXPRESSWAY
GRIFFIN, GA 30224
770-227-5757
www.homenurse.net
HomeNurse, Inc. is a leading provider of skilled nursing, certified nursing assistants, companion/sitters and home health aides. Founded in 1984, HomeNurse provides services for Work Comp, Medicaid, PPOs, MCOs, private insurance, private pay and various medical networks. HomeNurse serves all Georgia counties and is licensed by the Georgia Department of Human Resources as a Private Home Care Provider.

HYPERION RISK, INC. #103

PO BOX 622022
ORLANDO, FL 32862
407-859-0997
Hyperion Risk, Inc. headquartered in Orlando, Florida, is a nationwide leader in the provision of risk mitigation services to the insurance claims industry. Through onsite surveillance, claim investigations, background investigations and its dedicated proprietary technology, Hyperion Risk assists clients coast to coast in managing their claim exposure.

INTEGRATED CARE MANAGEMENT #13

5 DUNWOODY PARK, STE. 118
ATLANTA, GA 30338
800-500-3270
www.integratedcare.com
ICM (Integrated Care Management) is a full service managed care provider offering Workers' Compensation medical cost containment and disability management programs. ICM provides programs and solutions specifically designed to meet the unique needs of our customers for medical bill review & audits, telephonic & field case management and integrated disability management.

INTRACORP #58

3567 PARKWAY LANE, STE. 200
NORCROSS, GA 30092
770-449-5810
www.intracorp.com
Intracorp provides quality, cost-effective case management services to 28 million employees of companies nationwide. Intracorp offers utilization management, return-to-work programs, ergonomic consulting, provider bill review and provider network access. In March 2005, Business Insurance named Intracorp the nation's largest case management provider for the sixth consecutive year. www.intracorp.com or intracorpmarketing@email.intracorp.com

JOSEPH M. STILL BURN CENTER #91

3651 WHEELER ROAD
AUGUSTA, GA 30909
706-651-6399
www.josephmstillburncenter.com
The Joseph M. Still Burn Center is a 59 bed facility at Doctors Hospital in Augusta, GA. Treating over 2000 burn patients per year, our Burn Center is the largest facility of its kind in the United States. The Joseph M. Still Burn Center utilizes a multidisciplinary approach and is proud of our 96% survival rate.

LAW OFFICES OF BEVERLY MANLEY & ASSOCIATES, PC #105
 PO BOX 450534
 ATLANTA, GA 31145-0534
 770-493-4167
www.bmanleymsa.com

Medicare Set Aside Consultants with nationwide coverage. Onsite copy and pickup services is available upon request. Online case status inquiry availability. Our MSA allocations are completed by certified nurse life care planners with attorney review and signoff. Set fees with no unexpected charges regardless of complexity of case.

MDM DIATRI #108
 10965 HICKORY CREEK DRIVE, STE. 240
 MOKENA, IL 60448
 800-331-6062
www.diatri.net

MDM/DiaTri is a National Diagnostic PPO/Cost Management Company with center location in 47 states. MDM/DiaTri offers the most comprehensive solution for controlling cost in regards to diagnostic testing and scheduling. DiaTri offers a wide range of services including MRI/CT, bone scans, nuclear medicine, EMG/Nerve Conduction, myelogram & arthrogram.

MED-X MEDICAL TRANSPORTATION NETWORK #96
 PO BOX 720
 MATAWAN, NJ 07747
 888-777-9022

Med-X Medical Transportation Network is a leading provider of a nationwide medical transportation. Med-X recruits, credentials, inspects & manages a nationwide network of both ground and air transport providers. Our services include, Ground Ambulance, Air Ambulance, Medical Car, & Wheelchair Van transport. Our state of the art communications center is staffed 24 hours a day, 7 days a week. Our goal is to make transportation arrangements simple, quick and cost effective.

MEDICA STAND UP MRI OF ATLANTA #17
 6590 POWERS FERRY ROAD
 ATLANTA, GA 30339
 770-953-0108
www.standupmriatlanta.com

Medica Stand-Up MRI of Atlanta is pleased to introduce the only Stand-Up MRI in Georgia! Only this MRI lets the doctor see a complete picture of the patient's pathology when the patient experiences pain sitting, standing, or bending. This also offers claustrophobic and large patients a new era in imaging comfort.

MEDICAL SERVICES COMPANY #41
 11764 MARCO BEACH DRIVE
 JACKSONVILLE, GA 32224
 800-848-1989
www.medservco.com

MSC-Medical Services Company, is a Nationwide Leader in the delivery of medical products and pharmacy services to the workers' compensation industry. MSC serves both the workers' compensation insurance carrier as well as the injured worker. MSC provides true one-stop service for everything claimants need, quickly and conveniently.

MODERN MEDICAL #21
 7840 GRAPHICS WAY
 LEWIS CENTER, OH 43035
 800-547-3330
www.modernmedical.com

Modern Medical is the original, leading provider of electrotherapy equipment, durable medical equipment (DME), transportation services, language services, home health services and pharmacy benefit services for workers' compensation insurance carriers and self-insured companies nationwide. We specialize in service oriented cost containment and prompt, accurate responses to your claim needs.

NUQUEST/BRIDGE POINTE # 100
 P.O. BOX 915619
 LONGWOOD, FL 32791
 770-972-6750
www.nuquestbridgepointe.com

NuQuest/Brdge Pointe is a unique organization with the capability of providing One Source Medicare secondary payer compliance solutions. Along with our Medicare set-aside and professional administration services, we have assisted customers nationwide in developing internal protocols and extensive educational programs to ensure those protocols are successfully and consistently implemented.

NON-SURGICAL ORTHOPAEDIC & SPINE CENTER, PC #37
 335 ROSELANE STREET
 MARIETTA, GA 30060
 770-421-1420
www.lowbackpain.com

Non-Surgical Orthopaedic & Spine Center, PC specializes in the non-surgical treatment of neck and back pain. Our practice treats all orthopaedic conditions relating to the spine, including herniated discs, carpal tunnel syndrome, arthritis, fibromyalgia, tendonitis and repetitive motion injuries. Our services include comprehensive examinations, disability evaluations, customized pain management programs, Independent Medical Exams, EMG/NCS testing and rehabilitation programs. We recently built an onsite Outpatient Pain Center.

ONE CALL MEDICAL #18
 20 WATERVIEW BOULEVARD
 PARSIPPANY, NJ 07054
 973-257-1000
www.onecallmedical.com

One Call Medical, Inc. provides ancillary specialty PPO services to the workers' compensation industry; services include MRI/CT and EMG diagnostic procedures. Through One Call Medical's preferred network of over 2800 centers of excellence located in 45 states and its advanced process management expertise and capabilities, One Call Medical's customers receive immediate and substantial cost savings on diagnostic imaging and EMG examinations of their injured workers as well as expedited procedure turnaround time, leading to earlier return to work.

OPTIMAL TRANSLATION & TRANSPORTATION SERVICES #24
 309 CRANES ROOST BOULEVARD,
 STE. 2000
 ALTAMONTE SPRINGS, FL 32701
 877-210-9011
www.gotooptimal.com

Optimal Translation & Transportation is a national translation and transportation services company focused on meeting the needs of the workers' compensation, liability and legal industry. Our services fall into four categories; non-emergent transportation, on-site interpreting, telephonic interpreting and document translation. Referrals can be made by calling 1-877-210-9011.

ORTHOSPORT PHYSICAL THERAPY #111
 3450 ACWORTH DUE WEST ROAD,
 STE. 310
 KENNESAW, GA 30144
www.orthosportpt.org

Private PT Owned Company, Owner on-site. State of the art Pool, Hand & Ortho Center. Specializing in Results. Specialties include OrthoSpine (Total Spinal Rehab), OrthoWork (Back to work retraining and rehab), FCE's (reports in 3 days), Hand Center, general ortho & chronic pain proven programs. Marietta & Kennesaw/Acworth locations.

PAIN CONTROL & REHABILITATION INSTITUTE OF GEORGIA #12
 2784 N. DECATUR ROAD, STE. 120
 DECATUR, GA 30033
 404-297-1400

The Pain Control & Rehabilitation Institute of Georgia is a nationally recognized, multidisciplinary facility with over 23 years of experience in managing acute and chronic pain. Our services include management of Fibromyalgia, Reflex Sympathetic Dystrophy, spinal pain, headaches, work related injuries, motor vehicle accident injuries, Functional Capacity Evaluations, Impairment Ratings.

PAIN SOLUTIONS TREATMENT CENTERS #8
 55 WHITCHER STREET
 STE. 130
 MARIETTA, GA 30060
 770-590-1078
www.epainsolutions.com

Pain Solutions offers comprehensive pain management for the acutely injured worker and the worker suffering from chronic pain. Our doctors specialize in diagnostic and therapeutic interventions, IME's and impairment ratings, acupuncture, and intrathecal pump and SCS implantation and management. We are conveniently located in Marietta, Woodstock or Cartersville.

PATIENT FIRST TRANSPORT #57
 6050 PEACHTREE PARKWAY, STE. 240-171
 NORCROSS, GA 30092
 770-480-1535
www.patient1st.net

Patient First Services is a non-emergency transportation and interpretation company in the state of Georgia. We currently service the entire southeast providing ambulatory, wheelchair, and stretcher transportation. We are proud of our high success rate in the field, which is a result of our dedication to patients and insurance companies.

PEACHTREE ORTHOPAEDIC CLINIC #30
 2001 PEACHTREE ROAD, NE, STE. 705
 ATLANTA, GA 30309
 404-355-0743
www.pocatlanta.com

Peachtree Orthopaedic Clinic physicians have a wide range of orthopaedic interests and specialties, including: Arthritis Surgery, Total Joint Reconstruction and Replacement, Treatment of Deformities and Diseases of the Spine, Pediatric Orthopaedics, Hand Surgery, Shoulder and Elbow Surgery, Foot Surgery, Trauma Surgery, Sports Medicine and Arthroscopic Surgery.

PEACHTREE SPINE PHYSICIANS #29
 5555 PEACHTREE DUNWOODY ROAD,
 STE. G99
 ATLANTA, GA 30342
 404-843-3323
www.peachtreesspine.com

Peachtree Spine Physicians specializes in minimally invasive procedures to treat conditions such as, Herniated/Bulging Disks Pain, Low Back Pain, Whiplash Injury and Pain Syndrome. Our office makes every effort to see patients in a timely manner and maximize the quality of time spent with the physician.

PHYSICIAN PARTNER #84
 3607 OLD CONEJO ROAD
 THOUSAND OAKS, CA 91320
 805-375-0800
www.physicianpartner.com

Physician Partner specializes in providing pre-packaged medication and injectables to physicians, clinics and dentists for in-office dispensing. In-office dispensing enhances patient compliance while adding an additional profit center for the clinic or practice. We offer financial services for Workers' Compensation claims processing, full practice billing services and credit card processing solutions.

PHYSIOTHERAPY ASSOCIATES, INC. #88
 3280 HOWELL MILL ROAD, STE. 139
 ATLANTA, GA 30327
 770-490-2104

Physiotherapy Associates offers 500 outpatient rehabilitation clinics nationally. Our 41 Georgia clinics provide superior customer service to you and your Workers' Compensation patient. We excel in work conditioning, FCE's, custom splinting, hand therapy, complex spinal injuries, aquatics, orthotics and job site analysis. Physio's WC Express Referral - 1-888-Physio1 or 1-888-749-7461.

PINNACLE ORTHOPAEDICS #73
 1668 MULKEY ROAD, STE. A
 AUSTELL, GA 30106
 678-842-5402

Pinnacle Orthopaedics offers comprehensive care in correcting musculoskeletal abnormalities and injuries. Our 24 physicians have a wide range of orthopaedic interests, including arthroscopic surgery, surgery of the spine, hand pain management, and treatment of work related injuries. Pinnacle Orthopaedics & Sports Medicine Specialists has offices throughout the northwest Atlanta area, including Carroll, Cherokee, Cobb, Douglas, Paulding and Pickens Counties.

PRACTICE PARTNERS

2901 SW 149TH AVENUE, STE. 140
MIRAMAR, FL 33028
954-874-4609

Practice Partners, Inc. and its affiliate companies were founded by physicians who realized a need to streamline in-office medication dispensing, using innovative business solutions to assist Practitioners with their day to day healthcare needs using relentless service and technology, creating a paperless environment in the medication dispensing business.

PROVIDIAN FUNCTIONAL CAPACITY SPECIALISTS

PO BOX 9539
FLEMING ISLAND, FL 32006
904-982-5762

Providian Therapy and Functional Capacity Specialists provides Physical Therapy, Functional Capacity Evaluations, Work Conditioning, and Ergonomic Job Analysis throughout FL and GA. Our goal is to effectively return injured employees to work while making Adjusters and Case Managers lives easier.

PT SOLUTIONS

3950 COBB PARKWAY, STE. 103
ACWORTH, GA 30101
770-917-0924

www.pt-solutions.us

PT Solutions is privately-owned Physical Therapy practice, focusing on industrial rehabilitation and employee wellness. We assist industries by reducing lost workdays, injury-related costs, evaluation time, risk and exposure for injuries. Our objective is to advance worker fitness and health based on the goals of your company.

PMSI-TMESYS

175 KELSEY LANE
TAMPA, FL 33619
877-ASK-PMSI

www.pmsionline.com

PMSI is the largest nationwide full service, single-source provider of medications, medical supplies, durable medical equipment and specialty services for the workers' compensation and catastrophically-injured populations. In business since 1976, PMSI utilizes comprehensive clinical and case management strategies to enable workers' compensation professionals to optimize care outcomes while containing medical costs.

PTPN

PO BOX 5496
MARYVILLE, TN 37802
865-982-8334

www.ptpn.com

PTPN is the nation's first physical therapy provider network consisting of independently owned physical therapy clinics. Services provided are physical therapy, occupational therapy, speech therapy and hand therapy. Outpatient Rehabilitation services are a critical part of workers' compensation - restoring patient's health, reducing or avoiding disability, improving productivity and quality of life, avoiding rehospitalization, and in some cases, expensive and painful surgeries.

#65

R & R VAN LIFT, INC.

2130 SIGMAN ROAD
CONYERS, GA 30012
770-483-0767

www.rrvan.com

R & R Mobility has been providing Safe, Reliable and Innovative Transportation Solutions for the Physically Challenged since 1974. We are in a Category V - Q.A.P. member of N.M.E.D.A. We provide Sales and Service for all the major manufacturers of adaptive equipment and we have an excellent variety of vans in stock.

PROGRESSIVE MEDICAL, INC.

543 MCCORKLE BOULEVARD
WESTERVILLE, OH 43082
614-212-8514

www.progressive-medical.com

Progressive Medical, Inc. is a national network offering cost containment services and products to the managed care industry. Make one phone call to Progressive Medical and discover how partnering with us benefits you and your injured worker.

RESTORE NEUROBEHAVIORAL CENTER

200 GALLERIA PARKWAY, STE. 1800
ATLANTA, GA 30339
678-526-1589

www.restorehealthgroup.com

Restore Neurobehavioral Center is a residential post acute brain injury treatment program in Roswell, GA, specializing in behavioral sequela resulting from acquired brain injuries. Two distinct residential programs are available: Post Acute Rehabilitation and Supported Living Program. Scope of services include psychiatry medical management, neuropsychological counseling/evaluation, and licensed therapies. Each program is CARF accredited. 800-437-7972 ext. 8251 or www.restore-healthgroup.com

RESURGENS

ORTHOPAEDICS

5671 PEACHTREE DUNWOODY ROAD,
STE. 700
ATLANTA, GA 30342
404-847-9999

www.resurgens.com

Resurgens Orthopaedics is a team of highly committed professionals who make your medical care their top priority, and aspire to set a higher standard in orthopaedic care. WorkLink, Resurgens Orthopaedics Workers' Compensation Program assists employers in managing their workers' compensation claims, offering prompt access, up to date communication, and consistency with "dedicated contacts" in each of our 19 office locations.

ROOSEVELT WARM SPRINGS

PO BOX 1000
WARM SPRINGS, GA 31830
706-570-2377

www.roosevelt rehab.org

The Roosevelt Warm Springs Institute for Rehabilitation is an internationally known long-term acute care rehabilitation hospital treating patients with CVA, Spinal Cord Injury, and numerous Neurological and Orthopedic diagnoses. Other quality services include: Diabetic Foot Center, Outpatient Therapy Clinics, Vocational Rehabilitation, Seating Clinic, Rehab Technology and Drivers Education.

#75

RS MEDICAL

14401 SE FIRST STREET
VANCOUVER, WA 98684
866-835-7865

www.rsmedical.com

Relieve pain and restore muscle function with RS Medical neuro-electrical stimulators. Treat pain, spasms, disuse atrophy and other indications. Unmatched physician and patient services. More than 500,000 patients treated.

SANUWAVE, INC.

1841 WEST OAK PARKWAY, STE. A
MARIETTA, GA 30062
678-578-0149

The OssaTron is the first extracorporeal shockwave system approved by the U.S. Food and Drug Administration for the treatment of multiple orthopaedic conditions which have failed to respond to conservative treatment. Using shock wave technology to treat these conditions represents a non-invasive breakthrough allowing patients to return to work almost immediately.

SAFEHAVEN TRAUMATIC BRAIN INJURY FACILITY

PO BOX 69
ROCK SPRING, GA 30739
706-375-9520

Safehaven Traumatic Brain Injury Facility is a twelve bed facility located in Rock Spring, Georgia. We are a twenty four hour total care facility for the low level cognitive brain injured individual.

SHEPHERD PAIN INSTITUTE

2045 PEACHTREE ROAD, STE. 200
ATLANTA, GA 30309
404-355-1144

www.shepherdpaininstitute.org

The Shepherd Pain Institute offers pain management and rehabilitation for individuals experiencing acute and chronic pain problems. Because a variety of factors can contribute to an individual's pain, The Shepherd Pain Institute uses a multidisciplinary approach and a three-step treatment process of diagnosis, intervention & rehabilitation. Call 404-355-1144 for more information.

SMITH & NEPHEW

ORTHOPAEDICS
1450 BROOKS ROAD
MEMPHIS, TN 38116
901-396-2121

Helping people improve their lives with the Exogen Bone Healing System which accelerates healing of fresh fractures by 38% and is 86% successful in healing non-unions; and Supartz, the world's most prescribed joint fluid therapy for treatment of knee pain in osteoarthritis patients who fail to get adequate relief with exercise or painkillers.

SOUTHERN HOME CARE SERVICES

1700 E. PARK AVENUE
VALDOSTA, GA 31684
229-242-2797

www.southernhomecareservices.com

In business since 1978, Southern Home Care Services has the expertise and resources to effectively achieve client goals and outcomes. Available services include personal care/support, skilled nursing, medication management assistance, homemaker services, specialty care of brain-injured or disabled individuals, and respite care. High-tech skilled services are available in selected areas.

#31

SPEEDY RE-EMPLOYMENT MEDICARE SET-ASIDES

PO BOX 8049
DELRAY BEACH, FL 33482
800-985-3394/678-372-0845

www.speedyreemployment.com

Your partners in the process of Re-Employing injured workers and Medicare Set-Asides Services guaranteeing results through flat rate pricing, shared risk, and process timeline. Speedy Re-Employment fills the void in the transition between injury recovery and return-to-work. Please visit our website for more information at www.speedyreemployment.com or call Nicole Rivers at 678-372-0845 for your Re-Employment and Medicare Set-Asides needs.

SPINE CARE & PAIN MANAGEMENT

1620 PRINCE AVENUE
ATHENS, GA 30606
706-549-8114

www.tameyourpain.com

Our organization combines the skills of board certified physicians, certified physical therapists and registered nurses - all with the expertise and interests in managing chronic and acute pain. We have multiple non-invasive or minimally invasive treatment options available. We are located in Athens, Rome, Winder and Royston. Visit www.tameyourpain.com for more information.

TECHHEALTH

14025 RIVEREDGE DRIVE, STE. 400
TAMPA, FL 33637-2015
877-611-3415

www.techhealth.com

TechHealth provides the highest quality ancillary medical services with measurable outcomes at competitive rates for the workers' compensation arena. TechHealth provides diagnostic imaging, outpatient rehabilitation pharmacy, home health, and DME services.

THE DIRECTIONS GROUP

PO BOX 1108
MT. PLEASANT, SC 29465
843-843-0400

www.thedirectionsgroup.com

The Directions Group, Inc. is a regional company providing disability management services in Georgia, South Carolina, and North Carolina. We offer medical and vocational case management, catastrophic case management, vocational evaluation services, and life care planning. Our employees are experienced nurses and vocational rehabilitation counselors featured at www.TheDirectionsGroup.com

#113

#62

#74

#97

#85

#54

#110

#19

#40

#109

#76

#22 & 23

#66

#49

#56

#63

#53

THE EMORY ORTHOPAEDIC AND SPINE CENTER #101
59 EXECUTIVE PARK SOUTH
ATLANTA, GA 30329
404-778-7000

www.emoryhealthcare.org/departments/ortho
Situating conveniently just off I-85 at North Druid Hills Road, Emory Orthopaedics & Spine Center is Atlanta's newest and most comprehensive center for outpatient orthopaedic and spine care. Combined with the professional skills of over 30 of the most highly trained orthopaedic specialists, is an ambulatory surgery center, a physical therapy service and a complete imaging center providing on-site MRI and CT evaluations. Treating patients of all ages with all types of musculo-skeletal concerns, Emory Orthopaedics & Spine Center is a state-of-the-art facility bringing the best of academic medicine to all orthopaedic and spine patients.

THE ERGO COMPANY #46
PO BOX 920276
NORCROSS, GA 30010
770-446-2138
www.theergocompany.com

The ERGO Company provides comprehensive ergonomics program support for musculoskeletal injury prevention and management. Working with employers to re-tool and re-educate their workforce, The ERGO Company develops job hazard analyses, physical demands job analysis, transitional duty assignments, and functional capacity evaluations to improve worker safety and reduce workers' compensation costs.

THE FREEDMAN GROUP #36
1950 SPECTRUM CIRCLE
STE. B-316
MARIETTA, GA 30067
770-541-7401
www.TheFreedmanGroup.com

The Freedman Group provides Occupational and Physical Therapy treatments, Functional Capacity Evaluations, Ergonomic Job Site Assessments and Home Assessments. The goal of any of the services provided is to help people find new pathways to work around their problems with the ability to return to work and life skills.

THE HUGHSTON CLINIC #77
6262 VETERANS PARKWAY
COLUMBUS, GA 31901
706-494-3332
betchison@hughston.com
www.hughston.com

The physicians and physical therapists of the Hughston Clinic are recognized as international leaders in the field of orthopaedic and rehabilitation medicine. Their dedication, to a tradition of excellence in the treatment of musculoskeletal disorders, is unparalleled.

THE WRIGHT REHABILITATION SERVICES, INC. #9
213 RIVER PARK NORTH DRIVE
WOODSTOCK, GA 30188
770-592-8795
www.wrightrehab.com

The Wright Rehabilitation Services, Inc. was founded in 1994 and proudly serves the Southeast Region. We are involved in all aspects of disability management including multilingual, medical and vocational case management, vocational assessments and placement services, life care planning and Medicare Set-Aside Arrangements. WRS is dedicated to help our clients manage cases to successful conclusions.

TOTAL MEDICAL SOLUTIONS #90
1280 UPSALA ROAD
SANFORD, FL 32771
800-700-9393
www.newtms.com

Total Medical Solutions (TMS) provides a full range of ancillary services for the Workers' Compensation individual from specialty wheelchairs & ramping to the coordination of all home health care services. TMS will accommodate all of the needs of the injured worker. TMS is a nationwide service that specializes in the clinical management of longterm, life altering injuries.

TRANSLATION STATION #33
3921 FLOWERS ROAD
DORAVILLE, GA 30360
770-234-9387
www.translation-station.com

Translation Station, Inc.'s mission is to deliver unsurpassed levels of customer service by using qualified native speaking professionals to meet our clients' interpretation and translation needs in over 150 languages and dialects. Our services include interpretation for medical, legal, and insurance industries; translation of documents, including medical and legal. Please contact us at 770-234-9387 or sales@translation-station.com

TWIN LAKES PHYSICAL THERAPY #51
571 HAMMOCK ROAD, STE. 106
MILLEDGEVILLE, GA 31061
478-452-6252

Twin Lakes Physical Therapy Inc., provides comprehensive physical therapy and industrial rehabilitation services to the entire middle Georgia region, with three convenient locations: Milledgeville, Gray/Jones County, and the Greensboro/Lake Oconee area. We specialize in the prevention and treatment of industrial, musculoskeletal, orthopaedic, and sports injuries.

VINCENT E. BOSWELL, M.D., PC #11
285 BOULEVARD, NE, STE. 115
ATLANTA, GA 30312
404-588-1272
www.boswellmdpc.com

Vincent E. Boswell, M.D., P.C., is a solo orthopaedic practice located in midtown Atlanta providing general orthopaedic care emphasizing on workers' compensation and occupational medicine. The practice also performs Independent Medical Exams (IME's) and Fitness-for-Duty exams with on site radiology and spanish translation provided. Our Goal is to provide personal communication working cooperatively with case managers and employees to facilitate their return to optimal health status and back to the workplace.

VQ ORTHOCARE #83
18011 MITCHELL SOUTH
IRVING, CA 92614
800-266-6969
www.vqorthocare.com

VQ Ortho Care provides patient centered solutions through the use of orthopaedic rehabilitative products and services

WALTON REHABILITATION HEALTH SYSTEM #6

1355 INDEPENDENCE DRIVE
AUGUSTA, GA 30901
706-724-7746
www.wrh.org

Walton Rehabilitation Health System is the only comprehensive JCAHO and CARF accredited provider of physical medicine and rehabilitation in Augusta, GA. Services range from inpatient and outpatient programs for persons recovering from stroke, head injuries, orthopedic injuries, chronic pain and other disabling conditions to community re-entry, assisted living and wellness.

WELLBEINGS OCCUPATIONAL HEALTHCARE #60

6825 JIMMY CARTER BOULEVARD,
STE. 1100
NORCROSS, GA 30071
770-449-5161
www.wellbeingsocc.com

Wellbeings Occupational Healthcare was founded in 1999 by Dr. Jane T. St. Clair a board certified physician specializing in occupational medicine and industrial health. Wellbeings has surpassed others in providing businesses with time efficient and cost effective occupational medical services. Our Norcross and Midtown clinics serve clients throughout North Atlanta.

WELLSTAR HEALTH SYSTEM #68

677 CHURCH STREET
ATTN: REHAB SERVICES
MARIETTA, GA 30060
770793-5109
vicki.ford@wellstar.org

WellStar Health System is a fully integrated healthcare delivery system providing a full complement of industrial services: Occupational Health Services (including Workers' Compensation Injury Management) are offered at five sites, Long Term Acute Care, Homecare, DME, Inpatient and Outpatient Rehabilitation, Day Treatment, Functional Capacity Evaluation, Work Hardening/Work Conditioning, and Case Management.

WLT SOFTWARE OF FLORIDA, INC. #70

831 N. HERCULES AVENUE
CLEARWATER, FL 33765
727-442-9296

our Global Partner in Insurance Software, WLT offers Windows based integrated claims processing and administration software for medical, dental, vision, disability, worker's comp, bill review, drugs, FLEX, COBRA, managed care, capitation, CDHP's, 24-hour coverage, repricing, claims editing, premium billing, agent commissioning, autoadjudication, HIPAA, document scanning, EFT, EDI, Internet portal, ASP hosting options and more.

ZONECARE USA #39
PO BOX 8379
DELRAY BEACH, FL 33482
770-904-0581
www.zonecareusa.com

ZoneCare is a national Transportation, Translation, DME and Instant Interpreting Company. We specialize in the workers' compensation and liability markets. We have large national contracts with many payors. We work exclusively with many employers nationally.

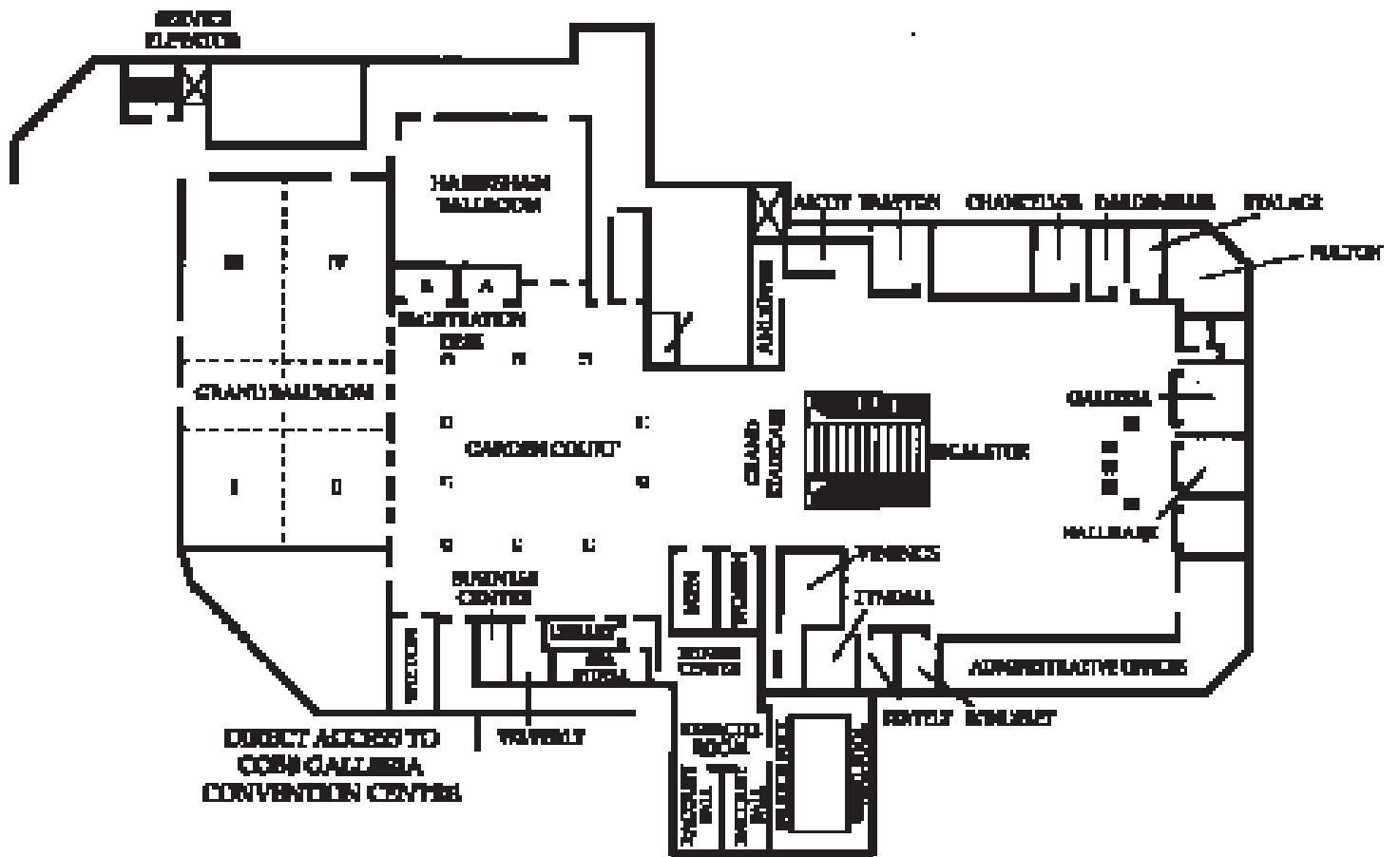

**RENAISSANCE WAVERLYHOTEL
MEETING ROOMS & BALLROOMS**

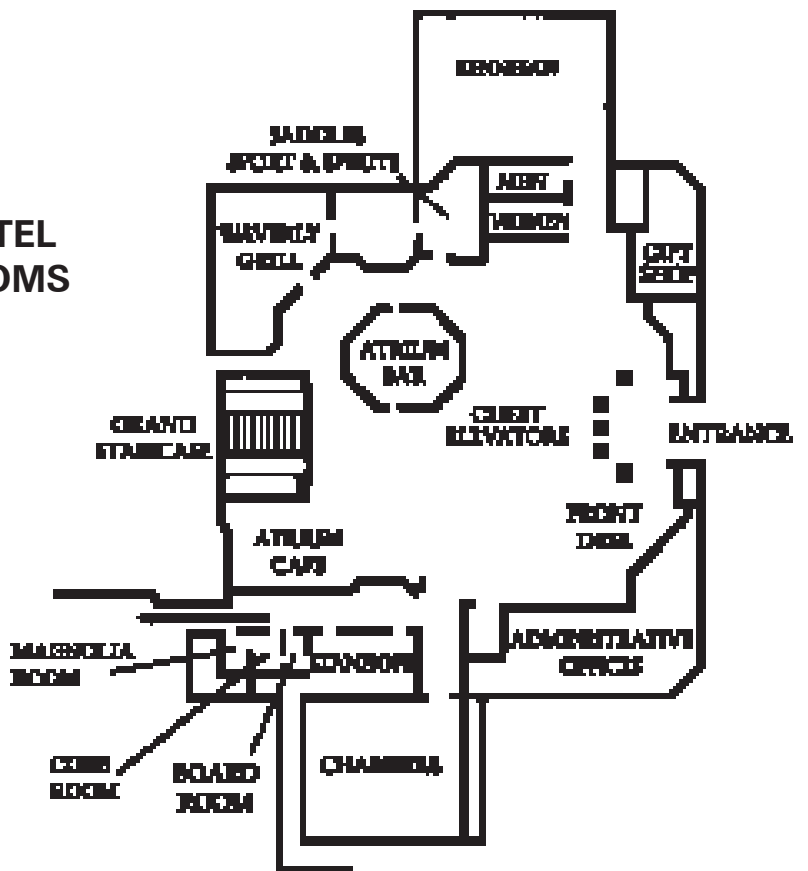

RENAISSANCE WAVERLY HOTEL GARDEN COURT - BALLROOMS 3 & 4

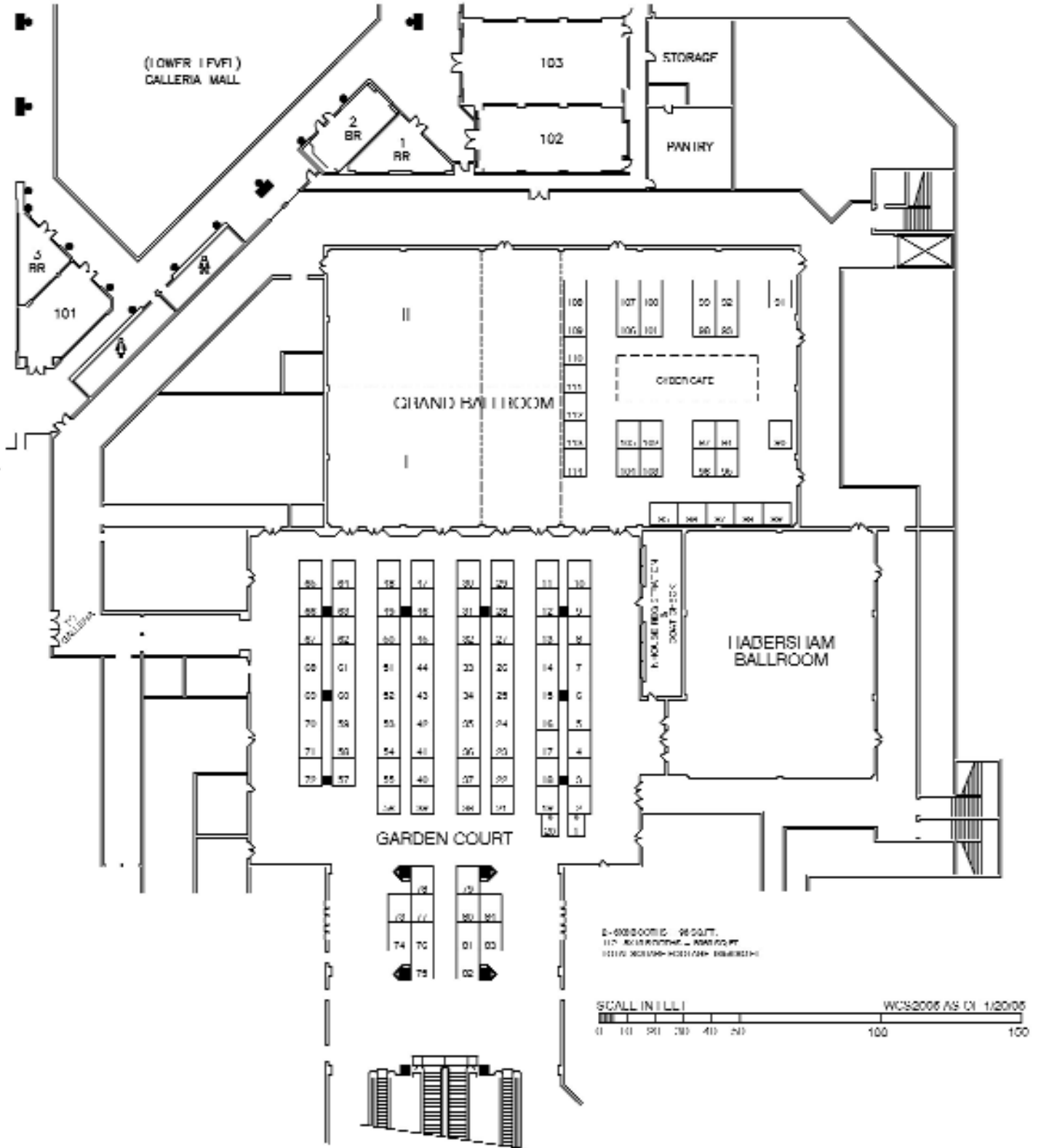

NOTES

NOTES

State Board of Workers' Compensation

